

36 324 001 EUROSMART COSMOPOLITAN E INFRA-RED ELECTRONIC BASIN MIXER WITH MIXING DEVICE AND ADJUSTABLE TEMPERATURE LIMITER

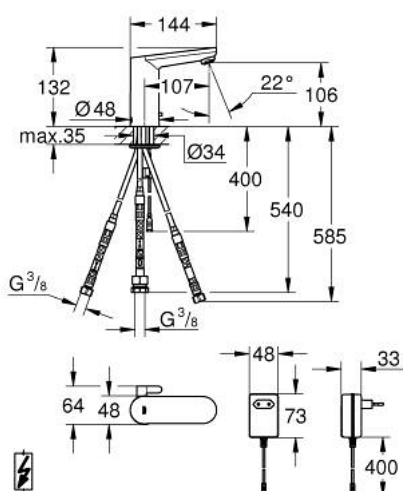

MÔ TẢ SẢN PHẨM

- Colour: chrome
- with infrared sensor for bi-directional communication for monitoring, configuration and servicing
- with plug transformer 100-230 V AC, 50-60 Hz, 6 V DC
- for open water heater
- Công nghệ GROHE EcoJoy tiết kiệm nước và đảm bảo lưu lượng hoàn hảo
- maximum flow rate (at 3 bar): 5.5 l/min
- fixed built-in static flow limiter on the hose connection
- non-return valve
- Bộ lọc bụi bẩn
- Dây cấp linh hoạt
- with integrated solenoid valve
- Công nghệ lắp đặt nhanh
- 7 pre-set programs:
 - auto flush
 - thermal disinfection
 - cleaning mode
- additional functions and precise settings by remote control 36 407
- CE approved
- Cấp chống ồn 1 theo DIN4109
- type of protection faucet IP 59K
- Áp suất tối thiểu 1,0 bar

36 324 001 EUROSMART COSMOPOLITAN E INFRA-RED ELECTRONIC BASIN MIXER WITH MIXING DEVICE AND ADJUSTABLE TEMPERATURE LIMITER

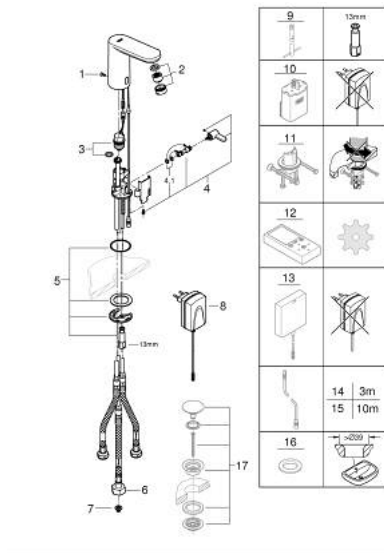

PHỤ KIỆN LẮP ĐẶT, tháng 4 2023 – now

- 1: Screw (Order-nr. 4283100M)
- 2: Flow straightener (Order-nr. 46162000)
- 3: Solenoid valve (Order-nr. 42469000)
- 4: Mixing lever (Order-nr. 42401000)
- 4.1: Seat washer (Order-nr. 4284000M)
- 5: Mounting set (Order-nr. 42400000)
- 6: Adapter with flow rate limiter (Order-nr. 42255000)
- 7: Filter (Order-nr. 4241300M)
- 8: Mains adaptor (Order-nr. 42388000)
- 9: Mounting wrench (Order-nr. 19017000)*
- 10: Battery housing with battery (Order-nr. 42393000)*
- 11: Rotation lock (Order-nr. 36276000)*
- 12: Remote control (Order-nr. 36407001)*
- 13: Switch-mode power supply (Order-nr. 36338000)*
- 14: Power extension cable (Order-nr. 36340000)*
- 15: Power extension cable (Order-nr. 36341000)*
- 16: Escutcheon (Order-nr. 36370000)*
- 17: Waste set with push-open plug (Order-nr. 65807000)*

* Phụ kiện đặc biệt